

0

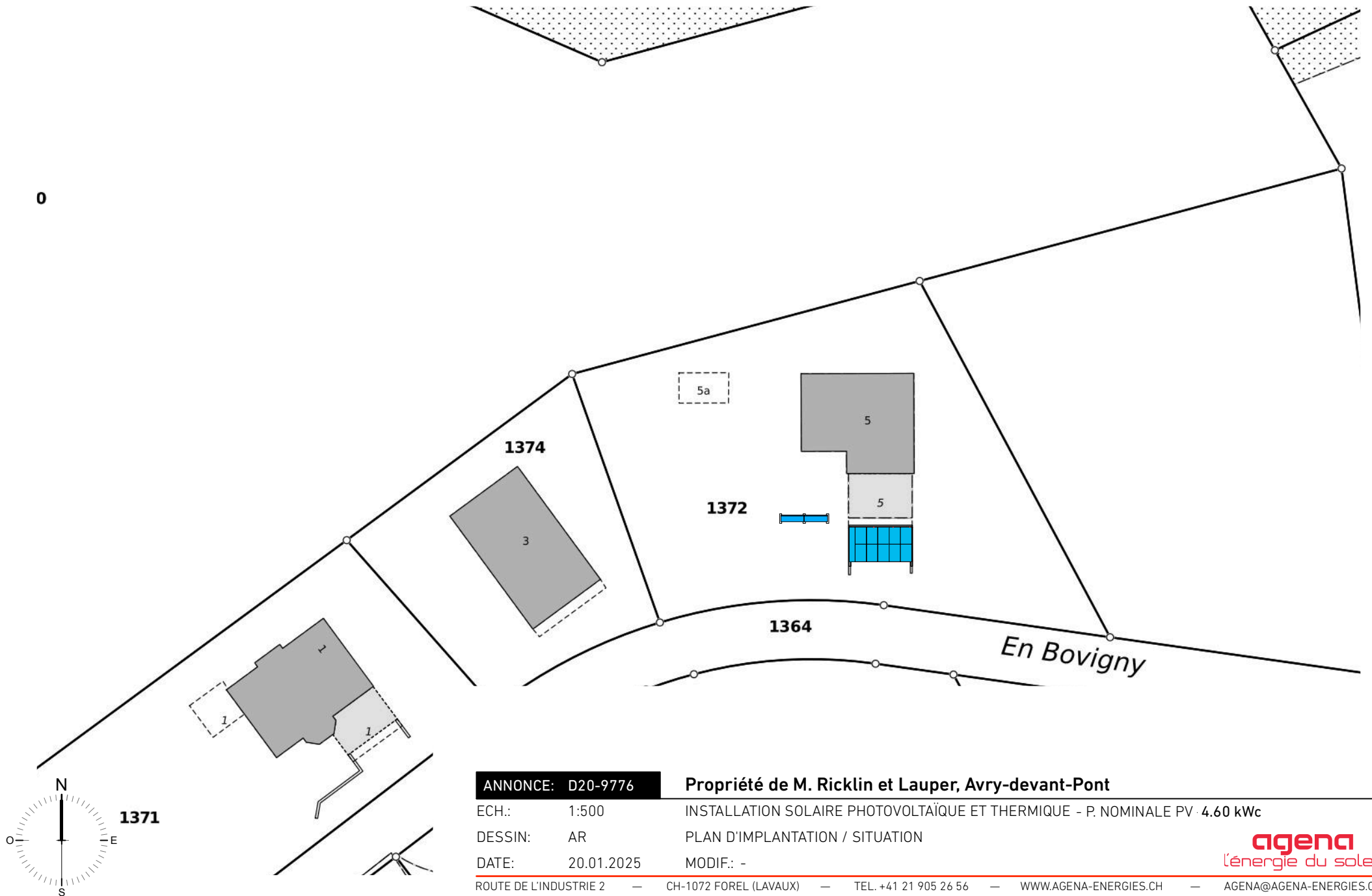

ANNONCE: D20-9776

Propriété de M. Ricklin et Lauper, Avry-devant-Pont

ECH.: 1:500

INSTALLATION SOLAIRE PHOTOVOLTAÏQUE ET THERMIQUE - P. NOMINALE PV : 4.60 kWc

DESSIN: AR

PLAN D'IMPLANTATION / SITUATION

DATE: 20.01.2025

MODIF.: -

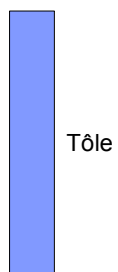
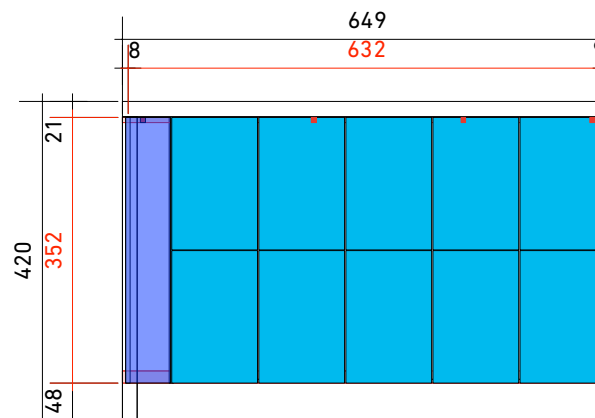
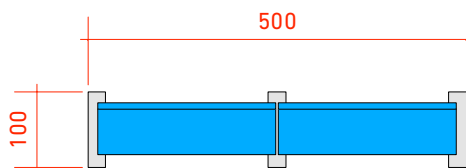
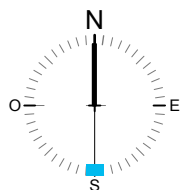

Tôle

Résumé de l'installation

☑ Modules orientation 0°	10 pces
🏠 Pente modules photovoltaïque	42°
Surface	19.924 m2

ANNONCE: D20-9776

Propriété de M. Ricklin et Lauper, Avry-devant-Pont

ECH.: 1:100/cm

INSTALLATION SOLAIRE PHOTOVOLTAÏQUE ET THERMIQUE - P. NOMINALE PV 4.60 kWc

DESSIN: AR

10 PCES AIKO Neostar - 460 Wc Noir/Noir/Noir - 1'757 x 1'134 x 30 mm

DATE: 20.01.2025

2 PCES CAPTEURS AZUR 8+



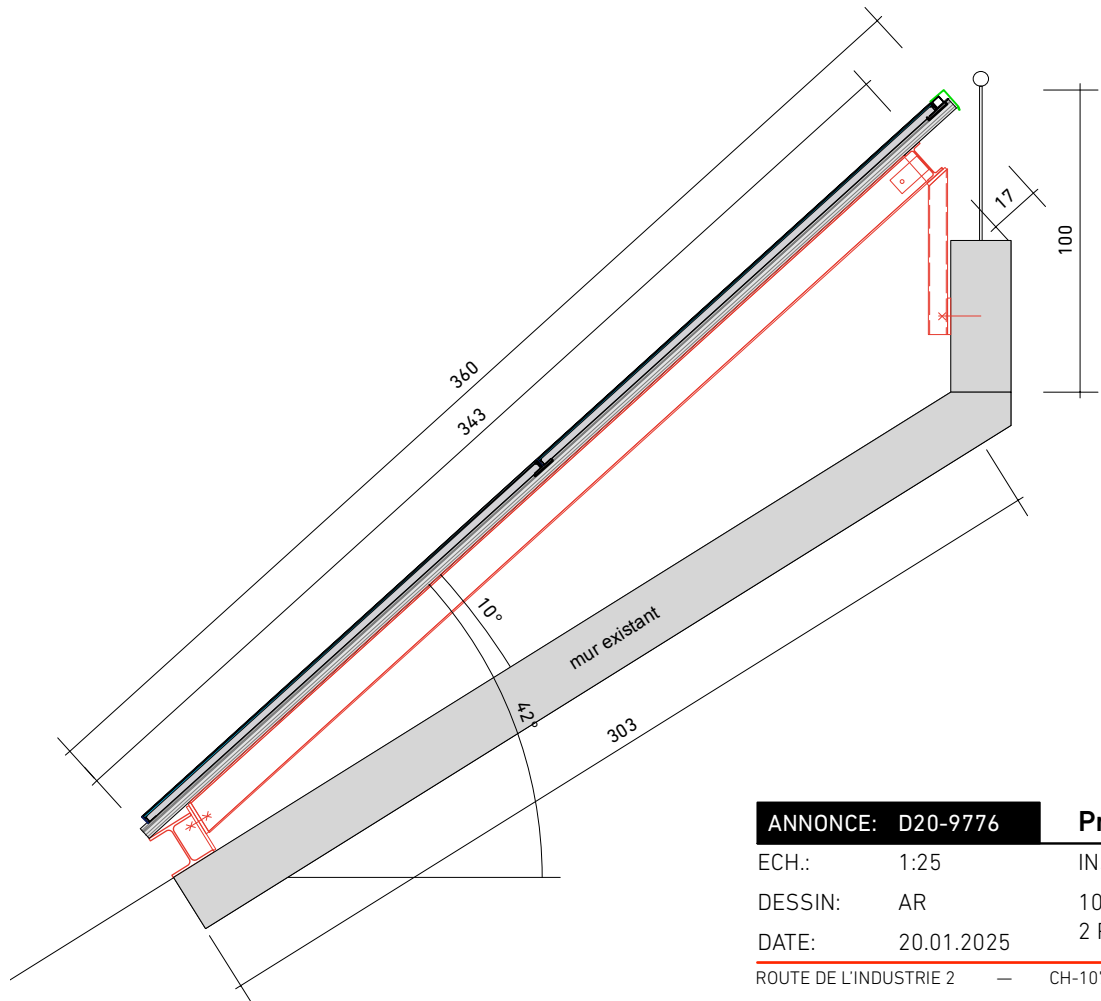
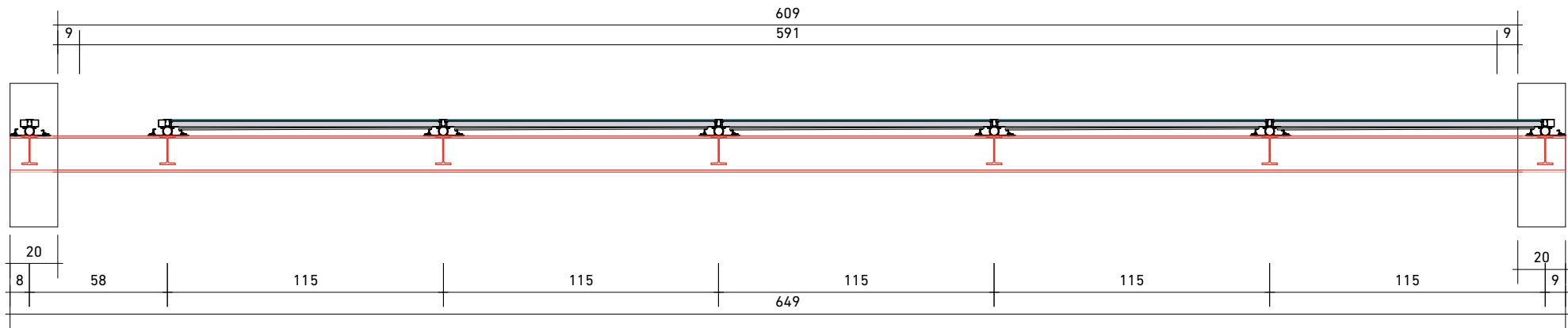

ANNONCE: D20-9776

Propriété de M. Ricklin et Lauper, Avry-devant-Pont

ECH.: 1:25

INSTALLATION SOLAIRE PHOTOVOLTAÏQUE ET THERMIQUE - P. NOMINALE PV · 4.60 kWc

DESSIN: AR

10 PCES AIKO Neostar - 460 Wc Noir/Noir/Noir - 1'757 x 1'134 x 30 mm

DATE: 20.01.2025

2 PCES CAPTEURS AZUR 8+

